

ZONE PROTECTION:
 (954) 376-7173
ZP. DESIGNER: TED HOWARD
 (954) 907-4011

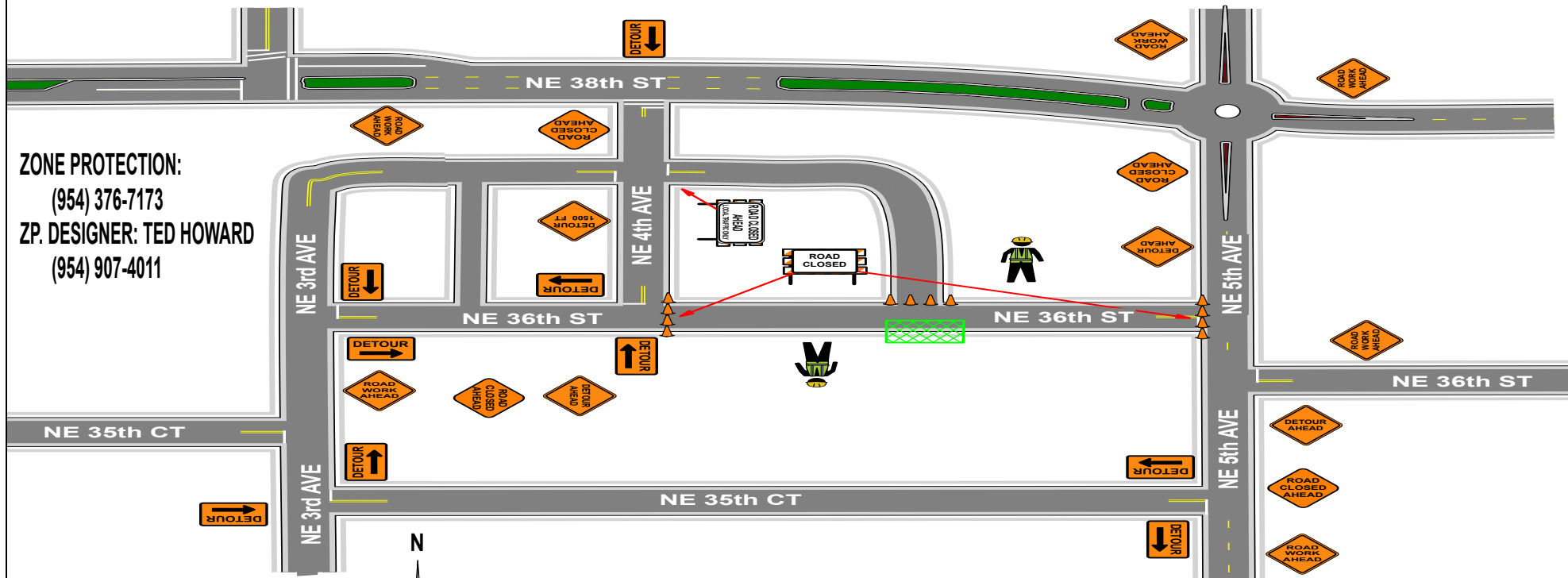

SPEED LIMIT 30 MPH

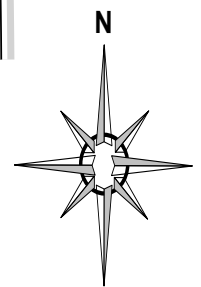

**Table I
Device Spacing**

Speed (mph)	Max. Distance Between Devices (ft.)			
	Cones or Tubular Markers		Type I or Type II Barricades or Vertical Panels or Drums	
	Taper	Tangent	Taper	Tangent
25	25	50	25	50
30 to 45	25	50	30	50
50 to 70	25	50	50	100

DISTANCE BETWEEN SIGNS

Speed	Spacing (ft.)		
	A	B	C
40 mph or less	200	200	200
45 mph	350	350	350
50 mph	500	500	500
*55 mph or greater	2640	1640	1000

**Table II
Buffer Space and Taper Length**

Speed (mph)	Buffer Space (ft.)	Taper Length (12' Lateral Transition)		Notes (Merge)
		L (ft.)	L (ft.)	
25	155	125		$L = \frac{WS^2}{60}$
30	200	180		
35	250	245		
40	305	320		
45	360	540		$L = WS$
50	425	600		
55	495	660		
60	570	720		
65	645	780		
70	730	840		

NOTES:
 THIS M.O.T IS BASED ON THE MUTCD & THE FLORIDDA DEPARTMENT OF TRANSPORTATION ROADWAY & DESIGN STANDARDS. ALL TRAFFIC CONTROL DEVICES MUST BE SET & PLACED BY PERSONS CERTIFIED IN TRAFFIC CONTROL DEVICE PLACEMENT AND PLANNING. TRAFFIC CONTROL DEVICES MAY NEED TO BE ADJUSTED TO FIT FIELD CONDITIONS.

COMMENTS:
 Type of Road: Arterial
 Traffic Volume: Moderate to Heavy
 All signs & devices shall be placed in accordance with the latest provisions of FDOT Design Standards Index 600 and or the Manual on Uniform Traffic Control Devices (MUTCD) with respect to any applicable provisions from the City of Oakland Park, FL.
 Access to residential and commercial driveways to be maintained at all times. If it is not possible to maintain access, then closures shall be coordinated with the property owner and or user.
 Sign placement is approximate and may be adjusted to accommodate field conditions.
PLANS ARE NOT TO SCALE.

SCOPE OF WORK:
 - INSTALLATION OF CONCRETE POLE
 - MAINTENANCE OF FPL FACILITIES

FDOT This Certifies that Theodore R. Howard Jr. Has Completed a Florida Department of Transportation Approved Temporary Traffic Control (TTC) Advanced (Refresher) Course.
 Date Expires: 07/21/2023 Certificate # 53777
 Instructor: Timothy Davenport FDOT Provider # 224
 Guardian MOT Safety Training
 Phone: 727-410-9124
 5400 Coraci Blvd #5204
 Port Orange, FL 34845
 guardiansafetytraining.com
 tdavenport24@gmail.com

Date: 03-12-2020
 Author: E. Lugo
 Location: Oakland Park, FL.
 Customer: Edison Power
 WR#: 9154455
 Designer: T. Howard

Proposed Start Date:
 February 12, 2021
Proposed End Date:
 February 13, 2021
Proposed Start Time(s):
 9:00AM - 4:00PM

SIDEWALK CLOSURE WILL BE UNDER 72 HOURS IN TOTAL.

All MOT shall conform with the MUTCD & FDOT Standards Index: MUTCD TA-20

Legend

- Cone
- Work Area
- ADA PEDESTRIAN BARRICADE
- FLAGGER